

STEP 1

Part # 70102



8 16596 01102 9

DU-HA[®]

DOWN UNDER-HOLDING APPARATUS

Fits DU-HA Part Numbers:

20096

20071

20072

20073

Installation Instructions for DU-HA Replacement Subwoofer Box (with amp) for 09-10 Ford F-150 Supercab

Materials Needed:

- // 8mm Socket
- // Phillips Screwdriver
- // Needlenose Pliers

To remove Factory Subwoofer:

- 1 Lift up rear passenger seat.
- 2 Remove 4 bolts pictured using an 8mm socket.
- 3 Turn subwoofer box over and unplug wires going into silver amp.
- 4 Remove 4 screws from amp box using a phillips screwdriver, then remove amp.
- 5 Remove 8 screws from the speaker using a phillips screwdriver as pictured.
- 6 Pull the speaker out of the box as far as possible. Apply light pressure up on the black tab under the speaker, gently wiggle the metal plugs free from the speaker using a needlenose pliers. Remove all 4 metal connectors from the speaker. Set speaker aside.
- 7 Pull cord that was originally plugged into the amp all the way out of the factory box.
- 8 Go to **"Step 2"** of installation instructions.

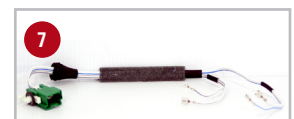

STEP 2

Part # 70102



8 16596 01102 9

DU-HA[®]

DOWN UNDER-HOLDING APPARATUS

Fits DU-HA Part Numbers:

20096

20071

20072

20073

Installation Instructions for DU-HA Replacement Subwoofer Box (with amp) for 09-10 Ford F-150 Supercab

Materials Needed:

- // Phillips Screwdriver
- // Flat Screwdriver
- // Needlenose Pliers
- // Original Speaker
- // Original Amp
- // Original Wire/Plug



To Install DU-HA Replacement Subwoofer Box:

- 1 Install amp on side of replacement subwoofer box in pre-drilled holes as pictured.
(Note: The amp plug should not go past the front of the box.)
- 2 Feed speaker wire (the end with the smaller connectors) through the hole on the outside of DU-HA subwoofer box to the inside of box, leaving amp plug on the outside.
- 3 Hook the connectors on the wires back to the speaker using a needlenose pliers.
(It doesn't make a difference which side the connectors hook into.)
- 4 Set the speaker in the subwoofer box and insert all eight screws into pre-drilled holes and tighten down as pictured.
- 5 Use flat screwdriver to help insert plug into box as pictured.
- 6 Plug in amp plug to amp.
- 7 Install finished DU-HA replacement subwoofer box inside DU-HA storage unit under back passenger seat of the truck. Pull Ford factory wire (on the floor on the passenger's side) over the back of the DU-HA and plug it into amp.

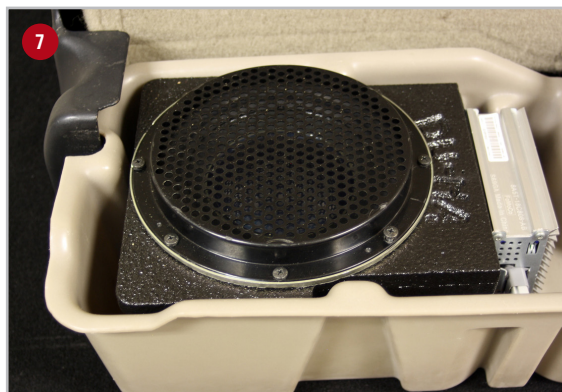
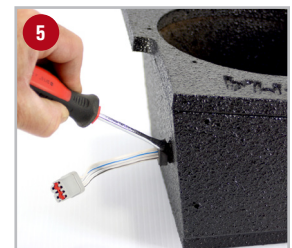
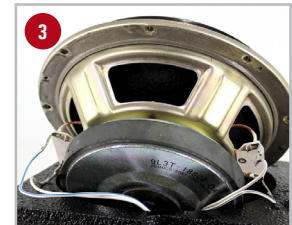
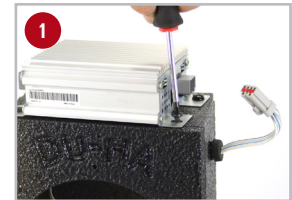

STEP 1

Part # 70102



8 16596 01102 9

DU-HA[®]

DOWN UNDER-HOLDING APPARATUS

Fits DU-HA Part Numbers:

20096

20071

20072

20073

Installation Instructions for DU-HA Replacement Subwoofer Box (without amp) for 11-12 Ford F-150 Supercab

Materials Needed:

- // 8mm Socket
- // Phillips Screwdriver
- // Needlenose Pliers

To remove Factory Subwoofer:

- 1 Lift up rear passenger seat.
- 2 Remove 4 bolts pictured using an 8mm socket.
- 3 Turn subwoofer box over and unplug green connection plug.
- 4 Pull out green plug still hooked to sub box.
- 5 Remove 8 screws from the speaker using a phillips screwdriver as pictured.
- 6 Pull the speaker out of the box as far as possible. Apply light pressure up on the black tab under the speaker, gently wiggle the metal plugs free from the speaker using a needlenose pliers. Remove all 4 metal connectors from the speaker. Set speaker aside.
- 7 Pull speaker cord all the way out from the factory subwoofer box.
- 8 Go to **"Step 2"** of installation instructions.

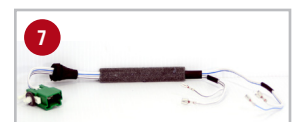
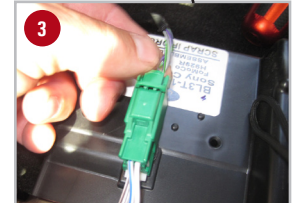

STEP 2

Part # 70102



DU-HA[®]

DOWN UNDER-HOLDING APPARATUS

Fits DU-HA Part Numbers:

20096

20071

20072

20073

Installation Instructions for DU-HA Replacement Subwoofer Box (without amp) for 11-12 Ford F-150 Supercab

Materials Needed:

- // Phillips Screwdriver
- // Flat Screwdriver
- // Needlenose Pliers
- // Original Speaker
- // Original Amp
- // Original Wire/Plug

To Install DU-HA Replacement Subwoofer Box:

- 1 Feed speaker wire (the end with the speaker connectors) through the hole on the side of DU-HA subwoofer box by the 'D' in 'DU-HA'.
- 2 Pull on the speaker wire from inside the speaker box, until plug on outside of subwoofer box is snug.
- 3 Plug hole on opposite side with plug provided.
- 4 Hook the connectors on the wires back to the speaker using a needlenose pliers. *(It doesn't make a difference which side the connectors hook into.)*
- 5 Set the speaker in the subwoofer box and insert all eight screws into pre-drilled holes and tighten down as pictured.
- 6 Install finished DU-HA replacement subwoofer box inside DU-HA storage unit under back passenger seat of the truck. Pull Ford factory wire (on the floor on the passenger's side) over the back of the DU-HA and plug the green ends together.

